



**Rack System
Warehouses**



Rack System Warehouses

The perfect fusion of building and storage system

Killing two birds with one stone! Thanks to the use of the hot-rolled steel sections the Ohra racking system supports can be used simultaneously to support your materials as well as being a load-bearing construction for roof and wall panels.

This is true for cantilever and palletized racks, as well as for combinations of both systems. What is important is the relationship between costs and benefits.

Ohra experience from more than 1,000 existing warehouses

For more than 30 years we have planned and implemented storage warehouses in Germany and abroad. Our customers benefit from many years of experience and the ideas of our well-trained technical consultants.

In the first meeting, you will have suggestions for your individual stock requirements, whether for a small annex, a workshop or for a large logistics project.

Racking warehouses from Ohra combine the necessary building functionality with the task of a conventional rack system - individual and cost effective!

Your advantages:

- Rack systems store your materials and at the same time provide the load-bearing construction for roof and wall
- Numerous models and warehouse types
- Cost advantages through complete Ohra planning and realisation
- On request turnkey construction for the client
- Experience from more than 1,000 existing warehouse projects
- Advice on warehouse construction, material flow, conveying and storage techniques from a single source
- Preparation of structural calculations, drawings and assembly instructions are included (for a fee)
- Complete cost control thanks to detailed design, manufacture and assembly
- Wide range of accessories for individual design

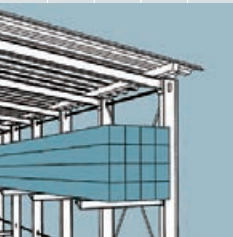
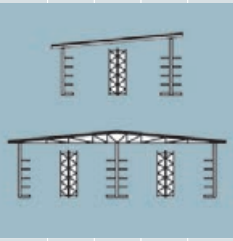

OHRA Rack System Warehouses



From planning to implementation

We plan your new warehouse with you. For each range and for each industry we will identify the most efficient solution. Critical to the success is the cost advantage of a rack warehouse. Stand-alone building construction as required for a conventional warehouse is eliminated.

Rack System Warehouses

Roof Designs

- Corrugated sheet metal with integrated translucent panels or integrated light domes.
- Canopy as a roof for loading zones
- As a single ventilated roof with anti drip coating
- Mono-pitch or saddle roof

Wall Designs

- Partially or fully closed
- Sheet pile wall between columns
- Gable and longitudinal wall panelling (e.g. from corrugated sheet metal)
- Different door designs and escape doors

Foundations

- Foundation slab
- Block foundation
- Strip foundation
- Sleeve foundation

Drainage

- Rain gutter (interior or exterior design)
- Downpipe, drainage

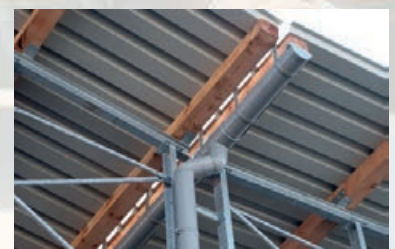

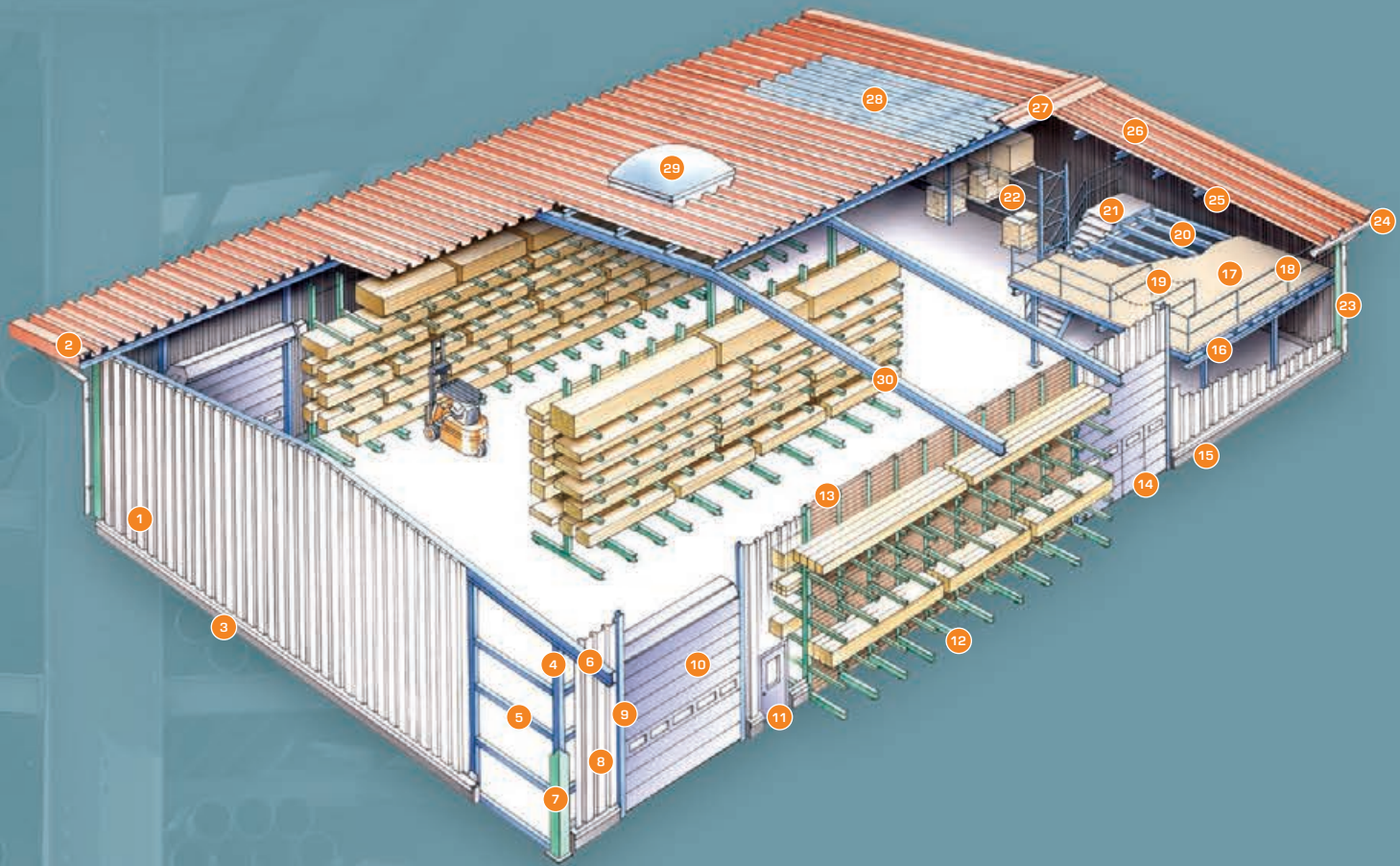

- | | | | | |
|--|---|--|------------------------|--|
| 1 End wall covering of trapezoidal sheet metal | 7 Corner protecting sheet metal | 13 Cladding supported between cantilever columns | 18 Handrail | 25 Purlin |
| 2 Edge flashing | 8 Trapezoidal sheet metal wall covering | 14 Roller shutter door with pedestrian door | 19 Pallet gate | 26 Roof covering trapezoidal sheet metal |
| 3 Horizontal flashing | 9 Door support steelwork | 15 Horizontal flashing | 20 Mezzanine steelwork | 27 Ridge plate |
| 4 Corner column | 10 Roller shutter door | 16 Steel mezzanine | 21 Stairs | 28 Clear roof panel |
| 5 Wall supporting bar | 11 Pedestrian door | 17 Mezzanine floor covering | 22 Pallet racking | 29 Roof light |
| 6 End wall steel work | 12 Cantilever racking | | 23 Down pipe | 30 Main roof steelwork |
| | | | 24 Rain gutter | |



Racking Warehouse Construction - closed design: Including roof covering and wall panelling. The installation of doors, emergency doors and drainage completes the racking warehouse construction.



Racking Warehouse Construction - open plan: From conventionally covered rack systems to open rack-clad warehouse. Complete with roof cladding and partial panelling.

Application Examples



Halfway closed cantilever rack-clad warehouse with hot-dip galvanized racks. Roof and wall of corrugated steel sheeting. Extension to an existing warehouse



Rack-clad warehouse at a large timber merchant. Roofing from corrugated steel sheeting, with clear panels. Designed as a narrow-aisle warehouse incl. guide rails.



Open cantilever rack-clad warehouse with two double rows of galvanized cantilever racks. With modern saddle roof construction and corrugated sheet metal covering. Large foundation slab.



Fully enclosed rack-clad warehouse with additional open annex of a covered, double-sided cantilever-racking row. Incl. lighting and clear panels over the aisles.



Timber storage with roof and wall panelling. Completely galvanized cantilever racks with guide rail as narrow-aisle warehouse. Clear panels in each aisle.



Rack structure, consisting of cantilever and pallet racks. Substructure including gable wall, shortly before the panelling. Block and sleeve foundations structurally computed.





Closed on three sides pallet rack-clad warehouse for the storage of timber with different assortments and dimensions in depth direction. Large roof projection.



Open cantilever rack-clad warehouse in timber trade. Complete with corrugated sheet metal roof covering incl. clear panels, gutter and downpipe. Block foundation with height compensation.



Open pallet rack warehouse for the storage of building materials. Double entry rack, fully galvanised, mounted on block foundations.



Open rack-clad warehouse. Combination of cantilever and pallet racks as a load-bearing construction for the roof. Bathed in light and with great span for truck passage.



Pallet rack warehouse at a builders merchants. Complete with roof and wall of steel deck, incl. roller shutter door and skylights. Additional protection of the rack frame against impact.



Open cantilever rack-clad warehouse with three double row galvanised cantilever racks. Modern saddle roof construction with 10 m span.

